

user manual

manuel d'utilisation | manual del usuario

Portable DVD Player



PHILIPS

Return your Product Registration Card today to get the very most from your purchase.

Registering your model with PHILIPS makes you eligible for all of the valuable benefits listed below, so don't miss out. Complete and return your Product Registration Card at once to ensure:

***Proof of Purchase**

Returning the enclosed card guarantees that your date of purchase will be on file, so no additional paperwork will be required from you to obtain warranty service.

***Product Safety Notification**

By registering your product, you'll receive notification - directly from the manufacturer - in the rare case of a product recall or safety defect.

***Additional Benefits of Product Ownership**

Registering your product guarantees that you'll receive all of the privileges to which you're entitled, including special money-saving offers.

PHILIPS

Congratulations on your purchase, and welcome to the "family!"

Dear PHILIPS product owner:

Thank you for your confidence in PHILIPS. You've selected one of the best-built, best-backed products available today. We'll do everything in our power to keep you happy with your purchase for many years to come.

As a member of the PHILIPS "family," you're entitled to protection by one of the most comprehensive warranties and outstanding service networks in the industry. What's more, your purchase guarantees you'll receive all the information and special offers for which you qualify, plus easy access to accessories from our convenient home shopping network.

Most importantly, you can count on our uncompromising commitment to your total satisfaction.

All of this is our way of saying welcome - and thanks for investing in a PHILIPS product.

P.S. To get the most from your PHILIPS purchase, be sure to complete and return your Product Registration Card at once.

Know these **safety** symbols



This "bolt of lightning" indicates uninsulated material within your unit may cause an electrical shock. For the safety of everyone in your household, please do not remove product covering.

The "exclamation point" calls attention to features for which you should read the enclosed literature closely to prevent operating and maintenance problems.

WARNING: To reduce the risk of fire or electric shock, this apparatus should not be exposed to rain or moisture, and objects filled with liquids, such as vases, should not be placed on this apparatus.

CAUTION: To prevent electric shock, match wide blade of plug to wide slot, fully insert.

ATTENTION: Pour éviter les choc électriques, introduire la lame la plus large de la fiche dans la borne correspondante de la prise et pousser jusqu'au fond.

For Customer Use

Enter below the Serial No. which is located on the rear of the cabinet. Retain this information for future reference.

Model No. _____
Serial No. _____

PHILIPS

Visit our World Wide Web Site at <http://www.philips.com>

IMPORTANT SAFETY INSTRUCTIONS

1. Read these instructions.

2. Keep these instructions.

3. Heed all warnings.

4. Follow all instructions.

5. Do not use this apparatus near water.

6. Clean only with dry cloth.

7. Do not block any ventilation openings. Install in accordance with the manufacturer's instructions.

8. Do not install near any heat sources such as radiators, heat registers, stoves, or other apparatus (including amplifiers) that produce heat.

9. Do not defeat the safety purpose of the polarized or grounding-type plug.

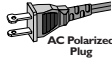

A polarized plug has two blades with one wider than the other. A grounding type plug has two blades and a third grounding prong. The wide blade or the third prong are provided for your safety. If the provided plug does not fit into your outlet, consult an electrician for replacement of the obsolete outlet.

10. Protect the power cord from being walked on or pinched, particularly at plugs, convenience receptacles, and the point where they exit from the apparatus.

11. Only use attachments/accessories specified by the manufacturer.

12. Use only with the cart, stand, tripod, bracket, or table specified by the manufacturer or sold with the apparatus. When a cart is used, use caution when moving the cart/apparatus combination to avoid injury from tip-over.

13. Unplug this apparatus during lightning storms or when unused for long periods of time.

14. Refer all servicing to qualified service personnel. Servicing is required when the apparatus has been damaged in any way, such as power-supply cord or plug is damaged, liquid has been spilled or objects have fallen into the apparatus, the apparatus has been exposed to rain or moisture, does not operate normally, or has been dropped.

15. Battery usage CAUTION – To prevent battery leakage which may result in bodily injury, property damage, or damage to the unit:

- Install **all** batteries correctly, + and - as marked on the unit.
- Do not mix batteries (**old and new or carbon and alkaline**, etc.).
- Remove batteries when the unit is not used for a long time.

16. Apparatus shall not be exposed to dripping or splashing.

17. Do not place any sources of danger on the apparatus (e.g. liquid filled objects, lighted candles).

18. This product may contain lead and mercury. Disposal of these materials may be regulated due to environmental considerations.

For disposal or recycling information, please contact your local authorities or the Electronic Industries Alliance : www.eiae.org.

EL 6475-E005: 04/01

Canada

English: This digital apparatus does not exceed the Class B limits for radio noise emissions from digital apparatus as set out in the Radio Interference Regulations of the Canadian Department of Communications.

PHILIPS LIMITED WARRANTY

**Ninety (90) Days Free Product Exchange
Ninety-One (91) Days-One (1) Year Reduced-Cost Exchange**

PHILIPS CONSUMER ELECTRONICS

warrants this product against defect in material or workmanship, subject to any conditions set forth as follows:

PROOF OF PURCHASE:

You must have proof of the date of purchase to exchange the product. A sales receipt or other document showing the product and the date that you purchased the product as well as the authorized retailer included, is considered such proof.

COVERAGE:

Warranty coverage begins the day you buy your product. For a period of ninety (90) days from the date of purchase, if the product is determined to be defective, Philips will exchange the defective product with a new or renewed product, at its option, at no charge.

From ninety-one (91) days to one year from the date of purchase, you will pay a preset exchange fee to obtain a new or renewed product. Contact the Customer Care Center for limited exchange pricing. This exchange opportunity ends one year after the date of purchase. The replacement product is covered only for the warranty period of the original product. When the warranty on the original product expires, the warranty on all replaced products also expires. When it is necessary for you to ship the product to Philips for exchange, you will pay the shipping cost for shipment to Philips. Philips will pay the shipping costs when returning a product to you.

Note: The exchange model supplied will be the most comparable one in Philips current inventory. Shipping of your product to Philips implies intent to follow the specified requirements of the warranty and exchange program. Product received by Philips cannot be returned. Replacement product can only be sent if all warranty requirements are met. Failure to follow all requirements can result in delay of exchange process.

EXCLUDED FROM WARRANTY COVERAGE

Your warranty does not cover:

- Shipping charges to return defective product.
- Labor charges for installation or setup of the product, adjustment of customer controls on the product, and installation or repair of antenna systems outside of the product.
- Product repair and/or part replacement because of improper installation, connections to improper voltage supply, abuse, neglect, misuse, accident, unauthorized repair or other cause not within the control of Philips.

- Damage occurring to product during shipping when improperly packaged or cost associated with packaging.
- A product that requires modification or adaptation to enable it to operate in any country other than the country for which it was designed, manufactured, approved and/or authorized, or repair of products damaged by these modifications.
- A product used for commercial or institutional purposes (including but not limited to rental purposes).
- Product lost in shipment and no signature verification receipt can be provided.
- Products sold AS IS or RENEWED.

WHERE WARRANTY EXCHANGE IS AVAILABLE:

Exchange is available in all countries where Philips officially distributes the product. In countries where Philips does not distribute the product, the local Philips organization will attempt to exchange the product, although there may be a delay if the appropriate product is not readily available, or special customs processes are implied.

FOR EXCHANGE IN THE U.S.A., PUERTO RICO, OR U.S. VIRGIN ISLANDS...

Contact Philips Customer Care Center at:
1-888-PHILIPS (1-888-744-5477)

FOR EXCHANGE IN CANADA...

1-800-661-6162 (French Speaking)
1-888-PHILIPS (1-888-744-5477) -
(English or Spanish)

REPLACEMENT AS PROVIDED UNDER THIS WARRANTY IS THE EXCLUSIVE REMEDY FOR THE CONSUMER. PHILIPS SHALL NOT BE LIABLE FOR ANY INCIDENTAL OR CONSEQUENTIAL DAMAGES FOR BREACH OF ANY EXPRESS OR IMPLIED WARRANTY ON THIS PRODUCT. EXCEPT TO THE EXTENT PROHIBITED BY APPLICABLE LAW, ANY IMPLIED WARRANTY OF MERCHANTABILITY OR FITNESS FOR A PARTICULAR PURPOSE ON THIS PRODUCT IS LIMITED IN DURATION TO THE DURATION OF THIS WARRANTY.

Some states do not allow the exclusions or limitation of incidental or consequential damages, or allow limitations on how long an implied warranty lasts, so the above limitations or exclusions may not apply to you. In addition, if you enter into a service contract agreement with the PHILIPS partnership within ninety (90) days of the date of sale, the limitation on how long an implied warranty lasts does not apply.

This warranty gives you specific legal rights. You may have other rights which vary from state/province to state/province.

Philips, P.O. Box 671539, Marietta, GA. 30006-0026

(Warranty: 4835 710 27475)

Contents

General information

Power Sources	2
Safety and maintenance	2
Handling discs	3
Environmental & copyright information	3

Functional Overview	4-5
----------------------------	-----

Remote Control	6-7
-----------------------	-----

Introduction	8-9
---------------------	-----

Preparations

Power supply	10-11
Connections	12

General explanation

About this manual	13
Remote control operation	13
Menu navigation	13

Basic functions

Switching on for OSD language setup	14
Loading discs and switching on	14
Playing a DVD disc	15
Playing an audio or video CD disc	15
Playing an MP3-CD	15
Playing a JPEG discs	15
Playing Divx [®] disc	15

General Features

Moving to another title / track / chapter	16
Still picture and step frame	16
Search	16
Slow motion	17
Changing the audio output	17
Zoom	17
Mute	17
Repeat	17
Repeat A>B	18
Play modes	18
Volume Control	18
Monitor	18
Sound	18

Special DVD features

Disc menu	19
Camera angle	19
Changing the language	19
Subtitles	19

OSD operations	20
-----------------------	----

SETUP operations	21-23
-------------------------	-------

Troubleshooting	24-25
------------------------	-------

Technical data	26
-----------------------	----

General information

Power Sources

This unit operates on a supplied AC adaptor, car adaptor, or a rechargeable battery pack.

- Make sure that the input voltage of the AC adaptor is in line with the local voltage. Otherwise, the AC adaptor and unit may be damaged.
- Do not touch the AC adaptor with wet hands to prevent electric shock.
- When connecting with car power (cigarette lighter) adaptor, be sure the input voltage of the adaptor is identical with car voltage.
- Unplug the AC adaptor from the outlet or remove the battery pack when the unit is not used for long periods of time.
- Hold the plug to disconnect the AC adaptor. Do not pull the power cord.

Safety and maintenance

- Do not disassemble the unit for laser rays are dangerous to eyes. Any service should be done by qualified service personnel.
- Unplug the AC adaptor to cut the power if liquid or objects get inside the unit.
- Take care not to drop the unit or subject it to strong shocks, which may cause malfunction.

- Hearing safety: listen at a moderate volume. Using headphones at high volume can impair your hearing.

Important (for models with bypacked headphones):

Philips guarantees compliance with the maximum sound power of its audio players as determined by relevant regulatory bodies only with the original model of provided headphones. In case this one needs replacement, we recommend that you contact your retailer to order a model identical to that of the original provided by Philips.

- Traffic safety: do not use while driving or cycling as you may cause an accident
- Do not expose to excessive heat caused by heating equipment or direct sunlight.
- This product is not waterproof: do not allow your player to be submersed in water. Water entering the player may cause major damage.
- Do not use any cleaning agents containing alcohol, ammonia, benzene, or abrasives as these may harm the player.
- Do not touch the lens!
- Apparatus shall not be exposed to dripping or splashing. Do not place any sources of danger on the apparatus (e.g. liquid filled objects, lighted candles)

Note: When the player is in use for a long period of time, the surface will be heated. This is normal.

Handling discs

- Do not attach paper or tape to the disc.
- Keep the disc away from direct sunlight or heat sources.
- Store the disc in a disc case after playback.
- To clean, wipe the disc outwards from the center with a soft, lint-free clean cloth.



Environmental information

We have reduced the packaging to its minimum and made it easy to separate into mono materials: cardboard, PS, PE and PET.

Your set consists of material which can be recycled if disassembled by a specialized company. Please observe the local regulations to dispose of packaging, exhausted batteries and old equipment.

Copyright information

"DivX, DivX" Certified, and associated logos are trademarks of DivXNetworks, Inc. and are used under license."

All other brand and product names are trademarks of their respective companies or organizations.

Unauthorized duplication of any recordings downloaded from the internet or made from CDs / VCDs / DVDs is a violation of copyright laws and international treaties.

The set complies with the FCC-Rules, Part 15 and with 21 CFR 1040.10. Operation is subject to the following two conditions:

- 1. This device may not cause harmful interference, and*
- 2. This device must accept any interference received, including interference that may cause undesired operation.*

Functional Overview

- | | |
|---|--|
| <p>① ⏮ / ⏭
For previous (⏮) or next (⏭) chapters, tracks or titles</p> <p>② ⏪ / ⏩
Search backward (⏪) or search forward (⏩)</p> <p>③ SETUP
Enters SETUP menu
MENU
Displays MENU page
MONITOR
Selects display mode
OSD
On Screen Display on / off
SOUND
Virtual surround sound on / off</p> <p>④ ▲, ▼, ◀, ▶
Up / down / left / right cursor
OK
Confirms selection</p> <p>⑤ ▶
Starts / resumes playback</p> <p>⑥ ⏸
Pauses playback
■
Press twice to stop playback</p> | <p>⑦ ▲ OPEN
Opens disc door to insert or remove disc</p> <p>⑧ POWER/CHG
Power and charging indicator</p> <p>⑨ IR SENSOR
Remote sensor</p> <p>⑩ ON · POWER · OFF
Switches the player on / off</p> <p>⑪ VOLUME ▾
Volume control</p> <p>⑫ PHONES 1 & 2
Headphones jack</p> <p>⑬ AUDIO OUT
Audio output jack</p> <p>⑭ VIDEO OUT
Video output jack</p> <p>⑮ COAXIAL
Digital audio output jack (coaxial)</p> <p>⑯ DC IN 9V
Power supply socket</p> |
|---|--|

CAUTION

Use of controls or adjustments or performance of procedures other than herein may result in hazardous radiation exposure or other unsafe operation.

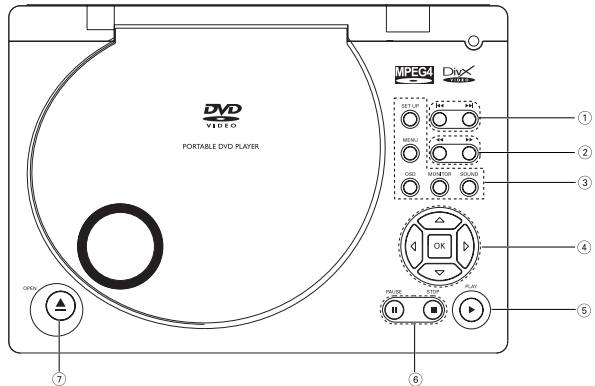

English

Main unit controls

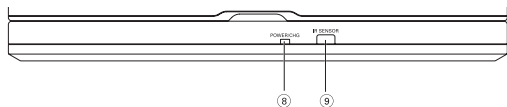

Front of player

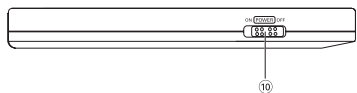

Left of player

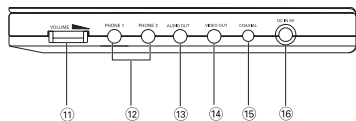

Right of player

Remote Control

- ① **▲, ▼, ◀, ▶**
Up / down / left / right cursor
OK
Confirms selection
- ② **VOL+ / -**
Volume control
- ③ **⏮ / ⏭**
For previous (⏮) or next (⏭) chapters, tracks or titles
⏸
Pauses playback
▶
Starts / resumes playback
■
Press twice to stop playback
⏮ / ⏭
Search backward (⏮) or search forward (⏭)
- ④ **OSD**
On Screen Display on / off
⏪
Slow motion
- ⑤ **AUDIO**
Audio language selector
ZOOM
Enlarges video image
- ⑥ **A > B**
To repeat or loop a sequence in a title
PLAY-MODE
Selects play order options
- ⑦ **0 - 9**
Numeric keypad
- ⑧ **MUTE**
Muting player volume
REPEAT
Repeats chapter / title / disc
- ⑨ **RETURN**
For VCD menu page
ANGLE
Selects DVD camera angle
- ⑩ **SUBTITLE**
Subtitle language selector
LANGUAGE
Language selector
- ⑪ **MENU**
Displays MENU page
- ⑫ **SETUP**
Enters SETUP menu

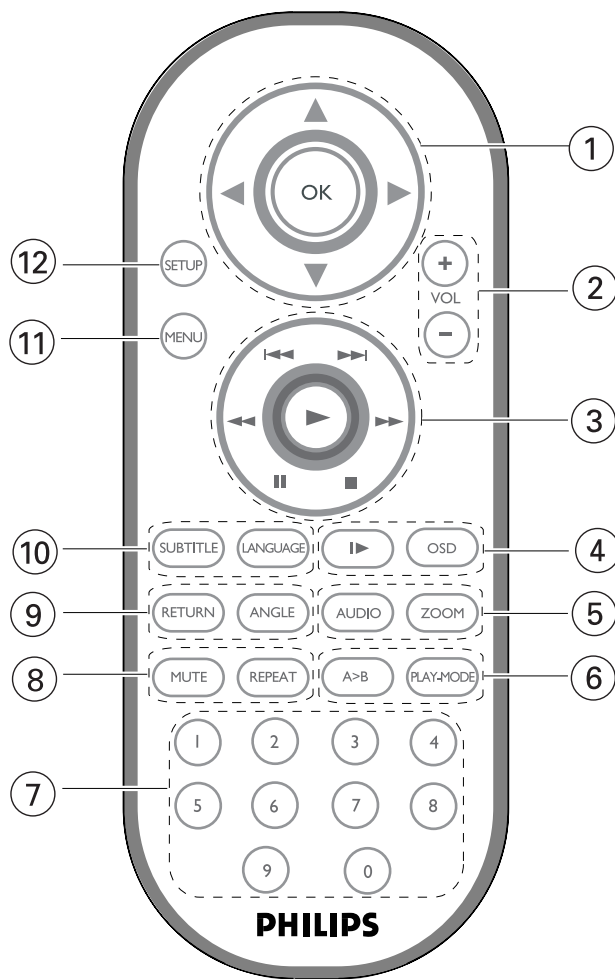

English

Introduction

Digital video

DVD-Video uses state-of-the-art MPEG2 data compression technology to register an entire movie on a single 5-inch disc. DVD's variable bitrate compression, running at up to 9.8 Mbits/second, captures even the most complex pictures in their original quality.

The crystal-clear digital pictures have a horizontal resolution of over 500 lines, with 720 pixels (picture elements) to each line. This resolution is more than double that of VHS, superior to Laser Disc, and entirely comparable with digital masters made in recording studios.

Your portable DVD player

Your portable DVD player plays digital video discs conforming to the universal DVD Video standard. With it, you will be able to enjoy full-length movies with true cinema picture quality, and stereo or multichannel sound (depending on the disc and on your playback set-up).

The unique features of DVD-Video, such as selection of soundtrack and subtitle languages, and of different camera angles (again depending on the disc), are all included.

What's more, parental lock lets you decide which discs your children will be able to see. You will find your player remarkably easy to use with the On-Screen Display and player display in combination with the remote control.

Unpacking

First check and identify the contents of your package, as listed below:

- Portable DVD player
- Remote Control
- Car adaptor (12V)
- AC power adaptor
- Rechargeable battery pack
- User Manual
- Warranty
- Audio / Video cable
- Travel bag (subject to region)

Placement

- Place the player on a firm, flat surface.
- Keep away from domestic heating equipment and direct sunlight.
- If the player cannot read CDs/DVDs correctly, try using a commonly available cleaning CD/DVD to clean the lens before taking the player to be repaired. Other cleaning methods may destroy the lens.
- Always keep the disc door closed to avoid dust on the lens.
- The lens may cloud over when the player is suddenly moved from cold to warm surroundings. It is then not possible to play a CD/DVD. Leave the player in a warm environment until the moisture evaporates.

Playable disc formats

In addition to DVD-Video disc, you will also be able to play all Video CDs and audio CDs (including CDR, CDRW, DVD+R and DVD+RW).

DVD-Video

Depending on the material on the disc (a movie, video clips, a drama series, etc.) these discs may have one or more Titles, and each Title may have one or more Chapters. To make access easy and convenient, your player lets you move between Titles, and also between Chapters.



Video CD

Depending on the material on the disc (a movie, video clips, a drama series, etc.) these discs may have one or more tracks, and tracks may have one or more indexes, as indicated on the disc case. To make access easy and convenient, your player lets you move between tracks and between indexes.



Audio CD / MP3 CD

Audio CDs / MP3 CD contain music tracks only. You can play them in the conventional way through a stereo system using the keys on the remote control and/or main unit, or via the TV using the On Screen Display (OSD).



CD with JPEG files

You can also view JPEG still photos on this player.

DivX video discs

You can also view discs containing DivX® video on this player.



- Official DivX® Certified™ product
- Plays DivX®5, DivX®4, DivX®3, and DivX® VOD video content.

Preparations

Power supply

Using the AC / DC adapter

Connect the supplied adapter to the set and the main power supply (as shown).

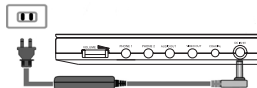

⇒ TIP

To avoid damage to the player, switch off before unplugging the AC adaptor.

Using the car adapter

Connect the supplied car adapter to the set and the car cigarette lighter outlet.

⇒ TIP

- To avoid damage to the player, switch off before unplugging the AC adaptor.
- When connecting with car power (cigarette lighter) adaptor, be sure the input voltage of the adaptor is identical with car voltage.

Powering your remote control

- ① Open the battery compartment.
Remove the protective plastic tab (first time users only).
- ② Insert 1 x lithium 3V battery, type CR2025, then close the compartment.

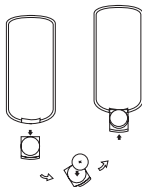

Batteries contain chemical substances, so they should be disposed of properly.

Incorrect use of batteries can cause electrolyte leakage and will corrode the compartment or cause the batteries to burst.

Remove the batteries if the set is not to be used for a long time.

Attaching and charging the battery pack

- ① Switch off the set. Attach the battery pack as shown.

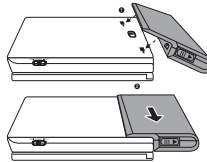

- ② Connect the supplied adapter to the set and the main power supply (as shown). Charge until the red indicator turns off (approximately 4.5 - 6.5 hours when unit is charged from power off).

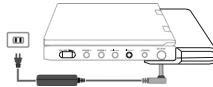

⇒ TIP

- It is normal for the battery pack to become warm during charging.
-  is shown on the screen when battery power is running out.

Detaching the battery pack

- ① Switch off the set.
- ② Unplug the AC adapter.
- ③ Turn the player upside down.
- ④ Press down the battery pack lock switch.
- ⑤ Slide off the battery pack as shown.

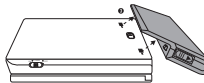
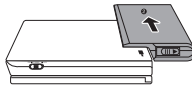

Connections

Connecting headphones

Connect the headphones into the **PHONE 1** or the **PHONE 2** jack of your set.

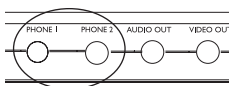

Connecting additional equipment

You can connect the player to a TV or an amplifier to enjoy DVDs or karaoke.

- ① Turn off your set before connecting to any additional equipment.
- ② Connect the output connectors (yellow / black) of the supplied cable to the **AUDIO /VIDEO** jacks. (**TV ON** on the main unit lights up)
- ③ Connect the input connectors (yellow, white and red) of the supplied cable to the additional equipment.

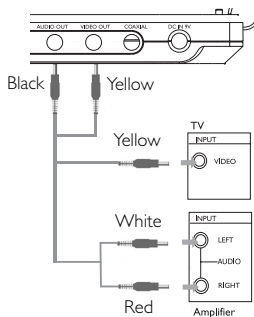

Connection	Video	Audio (Left)	Audio (right)
Color	Yellow	White	Red

⇒ TIP

- You can also make use of the COAXIAL jack for digital audio output.
- Please refer to the user manuals of your additional equipment for more information about connection.
- Players support NTSC/PAL/AUTO television sets.

General explanation

About this manual



This manual gives the basic instructions for operating this DVD player. Some DVD discs however are produced in a way that requires specific operation or allows only limited operation during playback. In these cases the player may not respond to all operating commands. When this occurs, please refer to the instructions in the disc inlay.

When a  appears on the screen, the operation is not permitted by the player or the disc.

Remote control operation

- Unless otherwise stated, all operations can be carried out with the remote control. Always point the remote control directly at the player, making sure there are no obstructions in the path of the infrared beam.
- When there are corresponding keys on the main unit, they can also be used.

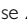
Menu navigation

- Your player has an intuitive menu navigation system to guide you through various settings and operations.
- Use the function keys to activate / disable relevant operations.
- Use , , ,  to browse through menus.
- Press **OK** key to confirm your selection.

Basic functions

Switching on for OSD language setup

English is the default language of your player's on screen display. You may choose to use English, French, Spanish, German, Simplified Chinese or Traditional Chinese for your player's on screen display.

Countries	OSD Language Options
European	English, French, Spanish, German
American	English
Asia Pacific	English, Traditional Chinese, Simplified Chinese

- ① Slide the **POWER** switch to **ON** to switch on the player.
- ② Press **SET UP** for the set up menu.
- ③ Select **GENERAL SETUP** and press **OK**.
- ④ Scroll and select **OSD LANG** and press **▶** to select from OSD language options.
- ⑤ Select your preferred language and press **OK**.

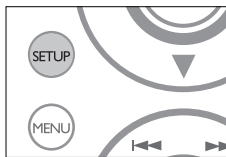

Loading discs and switching on

- ① Press **OPEN** to open the disc door.
- ② Insert your chosen disc, label side up (also when a double sided DVD disc is inserted). Make sure it is sitting properly in the correct recess.
- ③ Gently push to close the door.
- ④ Slide the **POWER** switch to **ON** to switch on the player.

⇒ TIP

- A normal mechanical noise is heard during playback.

Playing a DVD disc

After switching on, inserting the disc and closing the door, playback starts automatically. The screen shows the type of disc loaded.

The disc may invite you to select an item from a menu. Use the ▲, ▼, ◀, ▶ keys to highlight your selection, and press **OK**.

Note: Since it is usual for DVD movies to be released at different times in different regions of the world, all players have region codes and discs can have an optional region code. If you load a disc of a different region code to your player, you will see the region code notice on the screen. The disc will not play, and should be unloaded.

Playing an audio or video CD disc

After switching on, inserting the disc and closing the door, the screen shows the type of disc loaded as well as information about the disc's contents.

Press ▶ to start playback.

Playing an MP3-CD

The following playback features are available for MP3-CDs. Please refer to the corresponding sections for more information.

Volume control, skipping tracks, searching, repeat, shuffle, etc.

Use the ▲, ▼, ◀, ▶ keys to highlight your selected music folder. Press **OK**.

Playing a JPEG discs

Use the ▲, ▼, ◀, ▶ keys to highlight your selected picture folder.

Press **OK**. The player will then automatically enter the slide show mode.

Using the full display screen, this shows the rest of the JPEG files, one-by-one, located in the selected current folder.

Playing DivX® disc

- Philips provide you the DivX® VOD (Video on Demand) registration code that allows you to rent and purchase videos using the DivX® VOD service. For more information, visit www.divx.com/vod.
- Selection the DivX® VOD on the SETUP menu.
- The registration code will appear.
- Use the registration code to purchase or rent the videos from DivX® VOD service at www.divx.com/vod. Follow the instructions and download the video onto a CD-R for playback on this DVD player.

TIP:

All the downloaded videos from DivX® VOD can only be played back on this DVD player.

General Features

Note: Unless stated otherwise, all operations described are based on remote control operation.

Moving to another title/track/chapter

When a disc has more than one title or track, you can move to another title/track/chapter as follows:

- Press **▶▶** briefly during play to select the next title / track / chapter.
- Press **◀◀** briefly during play to step back to the previous title/track/chapter.
- To go directly to any title, track or chapter; enter the corresponding number using the numerical keys (0-9).



Still picture and step frame

Press **||** once or more for the following still picture and step frame options:

- || x 1** Pause / Still picture
- || x 2** screen shows **▶▶**



After the icon **▶▶** is displayed, press **||** repeatedly to play frame by frame. Press **OK** to resume normal playback.

Search

Press **▶▶** repeatedly for the following forward search options:

Press **◀◀** repeatedly for the following backward search options:

◀◀	▶▶
2 X backwards	2 X forward
4 X backwards	4 X forward
8 X backwards	8 X forward
16 X backwards	16 X forward
32 X backwards	32 X forward
normal speed	normal speed

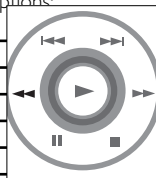

Press **OK** to resume normal playback.

Slow motion

Press **▶** once or more for the following slow play options:

x 1	1/2	x 5*	1/2 x backward
x 2	1/4	x 6*	1/4 x backward
x 3	1/8	x 7*	1/8 x backward
x 4	1/16	x 8*	1/16 x backward



Press **OK** to resume normal playback.

*for DVDs only

English

Changing the audio output

Press **AUDIO** repeatedly for the following audio options.

x 1	Mono left	x 2	Mono right
x 3	Mixed mono	x 4	Stereo



Zoom

The Zoom function allows you to enlarge the video image and to pan through the enlarged image.

Press **ZOOM** repeatedly to select the following zooming options.

Zoom x 1	2X	Zoom x 2	3X
Zoom x 3	4X	Zoom x 4	1/2
Zoom x 5	1/3	Zoom x 6	1/4
Zoom x 7	normal		

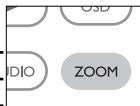

Mute

Press **MUTE** once to mute player volume.

Press **MUTE** again to disable.

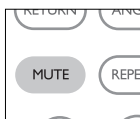

Repeat

Press **REPEAT** repeatedly for the following repeat options:

	DVD actions	VCD actions
x 1	repeats chapter	repeats track
x 2	repeats title	repeats all
x 3	repeats all	Cancels repeat
x 4	Cancels repeat	



General Features

Repeat A > B

To repeat or loop a sequence in a title:

- Press **A > B** at your chosen starting point;
 - ☞ **A** appears on the screen.
- Press **A > B** again at your chosen end point;
 - ☞ **AB** appears on the display, and the repeat sequence begins.
- To exit the sequence, press **A > B**.

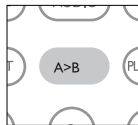

Play modes

Press **PLAY-MODE** repeatedly for the following play order options:

- x 1 Shuffle
- x 2 Random
- x 3 Program

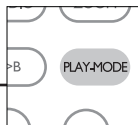

Use **(0-9)** to key in specific settings.

Volume Control

- Press **+ / -** to increase or decrease playback volume in the Remote Control or
- Use the rotary switch on the right side of the unit.



Monitor (on the main unit)

Press **MONITOR** repeatedly and use **◀ / ▶** to adjust brightness, color and display mode (normal or full screen).



Sound (on the main unit)

Press **SOUND** repeatedly to adjust virtual surround sound.



Special DVD features

Checking the contents of DVD-Video discs: **Menus**.

For titles and chapters, selection menus may be included on the disc. The DVD's menu feature allows you to make selections from these menus. Press the appropriate numerical key; or use the ▲, ▼, ◀, ▶ keys to highlight your selection, and press **OK**.

English

Disc menu

Press **MENU**. The menu may list, for example, camera angles, spoken language and subtitle options, and chapters for the title.



Camera angle

If the disc contains sequences recorded from different camera angles, the angle icon appears, showing the number of available angles, and the angle being shown. You can then change the camera angle if you wish.

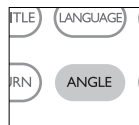

Press **ANGLE** repeatedly until you have reached your desired viewing angle.



To resume to normal viewing angle, press **ANGLE** repeatedly until no angle related message is shown on the screen.

Changing the language

Press **LANGUAGE**. If the current disc has different language options, this now appears on the screen.

Press **LANGUAGE** repeatedly until you have reached your desired language option.

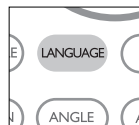

Subtitles

Press **SUBTITLES**. If the current disc has different subtitles options, this now appears on the screen. Press **SUBTITLES** repeatedly until you have reached your desired subtitles option.

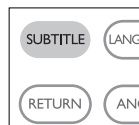

OSD operations

In addition to using remote control keys, you can also change disc playback options from OSD.

- 1 Press **OSD** during disc playback. A list of features is shown.
- 2 Use the **▲ ▼** keys to highlight your selection.

When the cursor highlights these settings, press **OK** to:

TITLE key in desired title number

CHAPTER key in desired chapter number

AUDIO select audio options

SUBTITLE select subtitle options

ANGLE select camera angle options

TT TIME key in starting point for title play time

CH TIME key in starting point for chapter play time

REPEAT select repeat options

TIME DISP. select time display options

- 3 Use **(0-9)** to key in specific settings.
- 4 Press **◀** to abort current setting or go back to previous menu level.
- 5 Press **OSD** to exit.

SETUP operations

To maximize your playback experience, use **SETUP** to fine tune your settings. Use the **▲▼◀▶** keys to highlight your selection, and press **OK**.

- ① Press **SETUP**. A list of features is shown.
- ② Use the **▲▼** keys to highlight your selection.

When the cursor highlights these settings, press **OK** to:

GENERAL SETUP select display and other options

AUDIO SETUP select audio options

PREFERENCES select playback preferences

PASSWORD SETUP select password options

EXIT SETUP Exit Setup

- ③ Press **◀** to abort current setting or go back to previous menu level.
- ④ Press **SETUP** to exit.

General Setup

When the cursor highlights these settings, press **OK** to:

TV DISPLAY	select display ratio
TV TYPE	select video standard of external TV set
OSD LANG	select on screen display language
SPDIF	select digital audio options
CAPTIONS	select captions options
SCREEN SAVER	select screen saver options

Press **◀** to abort current setting or go back to previous menu level

Audio setup

When the cursor highlights these settings, press **OK** to:

SPEAKER SETUP	select speaker options
DOLBY DIGITAL SETUP	select Dolby sound options
CHANNEL EQUALIZER	select equalizer options
3D PROCESSING	select surround sound options

Press **◀** to abort current setting or go back to previous menu level

Preferences

When the cursor highlights these settings, press **OK** to:

AUDIO	select audio language options
SUBTITLE	select subtitle language options
DISC MENU	select disc menu language options
PARENTAL	select parental options
DivX(R) VOD	get DivX ID for VOD
DEFAULT	Restore factory settings

Press **◀** to abort current setting or go back to previous menu level

Note: Parental options are only selectable when password mode is deactivated.

Password Setup

When the cursor highlights these settings, press **OK** to:

PW MODE	switch password on / off
PASSWORD	change existing password (default: 99999)

Press **◀** to abort current setting or go back to previous menu level

Troubleshooting

If it appears that the DVD-Video player is faulty, first consult this checklist. It may be that something has been overlooked.

WARNING

Under no circumstances should you try to repair the set yourself as this will invalidate the guarantee.

If a fault occurs, first check the points listed, before taking the set for repair. If you are unable to solve a problem by following these hints, consult your dealer or service centre.

Symptom	Remedy
No power	<ul style="list-style-type: none"> – Check if both plugs of the mains cord are properly connected. – Check if there is power at the AC outlet by plugging in another appliance. – Check if battery pack is inserted appropriately. – Check if car adaptor is connected appropriately.
Distorted picture	<ul style="list-style-type: none"> – Check the disc for fingerprints and clean with a soft cloth, wiping from centre to edge. – Sometimes a small amount of picture distortion may appear. This is not a malfunction.
Completely distorted picture / no colour with player menu	<ul style="list-style-type: none"> – The NTSC/PAL setting may be in the wrong status. Match your TV's setting with the player's setting.
No sound	<ul style="list-style-type: none"> – Check audio connections. If using a HiFi amplifier, try another sound source.

Symptom

Remedy

Disc can't be played

- Ensure the disc label is upwards.
- Clean the disc.
- Check if the disc is defective by trying another disc.

The player does not respond to the remote control

- Aim the remote control directly at the sensor on the front of the player. Avoid all obstacles that may interfere with the signal path. Inspect or replace the batteries.

Distorted or B/W picture with DVD

- Use only discs formatted according to the TV-set used (PAL/NTSC).

No audio at digital output

- Check the digital connections.
- Check the SETUP menu to make sure that the digital output is set to on.

Player does not respond to all operating commands during playback

- Operations are not permitted by the disc.
- Refer to the instructions in the disc inlay.

Player feels warm

- When the player is in use for a long period of time, the surface will be heated. This is normal.

Technical data

Dimensions	19.3 × 16.1 × 3.0 cm 7.72 × 6.44 × 1.2 inches
Weight	1.12 kg / 2.6 lb
Power supply	DC 9V 2.2A
Power Consumption	≤ 30W
Operating temperature range	0 - 50°C (32 ~ 122°F)
Laser wavelength	650nm
Video system	NTSC / PAL / AUTO
Frequency response	20Hz ~ 20KHz ± 1dB
Signal/noise ratio	≥ 85dB
Audio distortion + noise	≤ -80(1KHz)
Channel separation	≥ 85dB
Dynamic range	≥ 80dB
Output	
Audio out (analog audio)	Output level: 2V ± 10%
Load impedance:	10KΩ
Video out Output level:	1V _{p-p} ± 20%
Load impedance:	75Ω

PHILIPS reserves the right to make design and specification changes for product improvement without prior notice.

Modifications not authorized by the manufacturer may void users authority to operate this device.

All rights reserved.